

Smart Water Leakage Sensor User Manual

M414-30Ever1.0

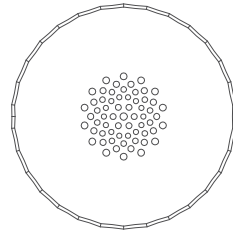

*Please read the user manual carefully before use.
Illustrations are for reference only, actual product may vary.

01/Product Introduction

The smart water leakage sensor based on the Thread wireless communication protocol, has high accuracy and sensitivity, long-term stability and longer battery lifespan.

The sensor seamlessly integrates with Matter-compatible hubs and other devices, triggering actions upon and intelligent scenarios when water leakage is detected.

The sensor part and processing part integrated design effectively prevent the impact of high humidity environment on the product. It can be widely used in the basement, machine room, hotel, kitchen, toilet, near the water tower, solar energy, etc.

01

02/Technical Parameters

Power Supply: DC3V(1×CR2032)

Wireless Protocol: Matter over Thread

Frequency: 2.4GHz - 2.48GHz

Wireless Range: Up to 60m (Open area)

Waterproof Rating: IP67

Operating Temperature: 0°C ~ +55°C

Operating Humidity: ≤95%RH(no condensation)

Dimensions: Φ42mm x H17.4mm

02

03/Illustrations

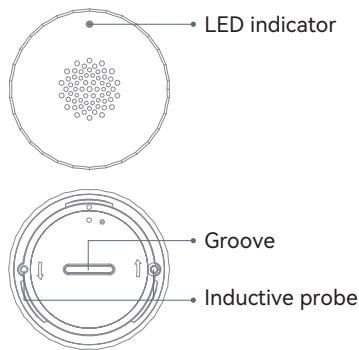

03

04/Notes

- Install the sensor in an area where water leakage may happen.
- Do not install the sensor in an area where there is rain, oily smoke or vapor.
- Do not install the sensor where there it's submerged by water already.

04

05/Networking

- Please make sure you have a Matter-compatible APP and a Matter-compatible Thread Border Router.
- Insert a coin into the groove to remove the battery cover by counter-clockwise rotation.

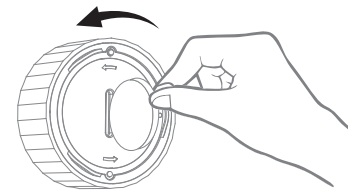

05

- Once the battery is installed into the device, the green LED indicator will flash quickly(5 times/second), indicating the device has entered networking status.

Notes: If green LED indicator does not flash, try to press reset button for 5 seconds till the green LED indicator flashes quickly, indicating the device has entered networking status.

Reset button

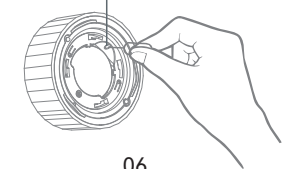

06

- Open the Matter-compatible APP and click the corresponding 'Add device' button. Then scan the Matter QR setup code in the manual or on the product to add the device to the APP.

- If networking inclusion is successful, the green LED indicator will be on for 3s and then goes off. If networking inclusion fails, the green LED indicator will flash slowly about 3s (twice/second).

Note: Press reset button again during networking status will stop networking process and green LED will flash slowly for 3s (twice/second) and go off.

07

! Tips

Due to the APP upgrade and update, this guideline may be slightly different from the actual operation, please follow the instructions in the APP.

08

After networking is done, align “⊙” on the battery cover to “●” on the sensor, and insert the coin to the coin slot to move the battery cover clockwise into the device. If “●” and “●” are aligned, it indicates the battery cover is locked firmly.

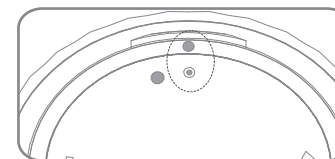

Battery cover is loosed.

09

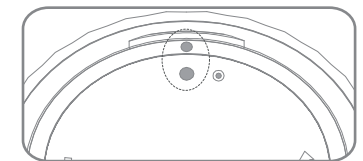

Battery cover is locked.

10

06/Visible Indication

Visible Indication	Status
Green LED	<ol style="list-style-type: none"> Flash quickly during network inclusion (5 times/second) Keep on for 2-3 seconds after networking is done. Flash slowly after networking fails
Red LED	Flash quickly once if the device issue alarms

11

07/Application



Put the sensor in the area where water leakage may happen.

12

08/Battery Replacement

- Insert a coin into the groove of the battery cover to remove it.
- Put a new battery into the battery compartment, and then move the battery cover back in place.
- * Pay attention to the positive and negative electrode of the battery.
- * Please dispose of used batteries in an environmental friendly way.

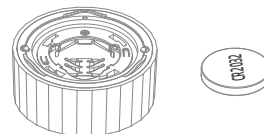

13

09/Safety Notice

BEFORE USING THE PRODUCT, PLEASE FAMILIARISE YOURSELF WITH ALL OF THE SAFETY INSTRUCTIONS AND INSTRUCTIONS FOR USE! WHEN PASSING THIS PRODUCT ON TO OTHERS, PLEASE ALSO INCLUDE ALL THE DOCUMENTS!

WARNING! DANGER TO LIFE AND RISK OF ACCIDENT FOR INFANTS AND

DANGER! Risk of suffocation!

14

- Never leave children unsupervised with the packaging material.
- The packaging material poses a suffocation hazard.
- Children frequently underestimate the dangers. The packaging material is not a toy.

Safety instructions for batteries

DANGER TO LIFE! Keep batteries out of reach of children. If accidentally swallowed seek immediate medical attention.

DANGER OF EXPLOSION! Never recharge non-rechargeable batteries.

15

- Do not short-circuit batteries and /or open them. Overheating, fire or bursting can be the result.
- Never throw batteries into fire or water.
 - Do not exert mechanical loads to batteries

Risk of leakage of batteries

- Avoid extreme environmental conditions and temperatures, which could affect batteries, e.g radiators /direct sunlight.
- If batteries have leaked, avoid contact with skin, eyes and mucous membranes with the chemicals! Flush immediately the affected areas with fresh water and seek medical attention!

16

WARNING

- **INGESTION HAZARD:** This product contains a button cell or coin battery.
- **DEATH** or serious injury can occur if ingested.
- A swallowed button cell or coin battery can cause **Internal Chemical Burns** in as little as **2 hours**.
- **KEEP** new and used batteries **OUT OF REACH of CHILDREN.**
- **Seek immediate medical attention** if a battery is suspected to be swallowed or inserted inside any part of the body



17



We care about our environment. Do not dispose of the appliance with usual household waste. Give it to an approved collection point for recycling.

18

EU DECLARATION OF CONFORMITY

Shenzhen Heiman Technology Co., Ltd. hereby declares that the product complies with directives 2014/30/EU, 2014/53/EU, 2011/65/EC. The full text of the EU declaration of conformity is available at the following internet address: <https://www.heimantech.com>



19

Statement:

*The illustrations shown are for reference only, and do not amount to any form of commitment. Please refer to the actual product;
*Given the continuous technological advancements, If the user manual and the actual operations are inconsistent, the final interpretation is reserved to the manufacturer.

20

Shenzhen Heiman Technology Co., Ltd.
www.heimantech.com
 Add: 101, No.4 Dafu Industrial Park, Kukeng Community, Guanlan Street, Longhua District, Shenzhen, China
 E-mail: inquiry@Heiman.com.cn

21